

# AutoGard Aliphatic

## Table of Contents

<b>7470 Chemical Resistance Chart</b>	Technical Bulletins	English	<b>2</b>
<b>Detail, Crack Treatment</b>	Detail Drawings	English	<b>3</b>
<b>Detail, Double-T Crack Control</b>	Detail Drawings	English	<b>4</b>
<b>Detail, Deck Drain</b>	Detail Drawings	English	<b>5</b>
<b>Detail, Typical Deck Flashing</b>	Detail Drawings	English	<b>6</b>
<b>Detail, Horizontal Termination</b>	Detail Drawings	English	<b>7</b>
<b>Detail, Through-Slab Crack Treatment</b>	Detail Drawings	English	<b>8</b>
<b>Detail, Vertical Projection</b>	Detail Drawings	English	<b>9</b>

# Chemical Resistance Chart

7470 series (47LJB)

Aliphatic Urethane

**Rating Key: 0 = No Effect; 1 = Stains/Dulls Film; 2 = Blisters Film; 3 = Lifts Film**  
Ratings are based on 7-day spot test.

Chemical	Rating	Chemical	Rating
Acetic Acid (10%)	0	Ketchup	1
Acetic Acid (36%)	2	Lactic Acid (20%)	1
Ammonia (28%)	0	Lactic Acid (85%)	2
Brake Fluid	3	Methylisobutyl Ketone	0
Butoxyethanol	1	Methylpyrrolidione	2
Butoxyethylacetate	0	Mineral Spirits	0
Butyl Alcohol	2	Motor Oil	0
Butylacrylate	2	Mustard	1
Calcium Chloride (10%)	1	Nitric Acid (10%)	1
Chromic Acid (2%)	2	Nitric Acid (30%)	3
Citric Acid (6%)	1	Oleic Acid	3
Citric Acid (70%)	2	Phenol	3
Diacetone Alcohol	1	Phosphoric Acid (25%)	2
Diesel Fuel	2	Potassium Hydroxide (25%)	0
Ethyl Acetate	0	Propylene Glycol	0
Ethyl Alcohol	2	Skydrol	2
Ethylene Glycol	0	Sodium Hydroxide (25%)	1
Formic Acid (38%)	2	Sodium Hydroxide (50%)	1
Gasoline	0	Sodium Hypochlorite (10%)	0
Hydrobromic (48%)	3	Solvent 100	0
Hydrochloric Acid (37%)	2	Sulphuric Acid (10%)	3
Hydrochloric Acid (5%)	1	Tall Oil Fatty Acid	2
Hydrofluoric Acid (24%)	0	Urine	1
Hydrofluoric Acid (48%)	0	Vegetable Oil	0
Isopropyl Alcohol	0	Vinegar	1
Jet Fuel	1	Xylene	1

Issued by: Hempel (USA) – 7470 CRC

This document is intended for professional use and provides generic advice in respect of the subject matter hereof only. It is not intended to be used as a comprehensive guide. The buyer/applicator should always read the relevant Product Data Sheets ("PDS"), Safety Data Sheets and Guide Specification relating to the applicable products/system. If in doubt, please contact your local Neogard representative for further advice. To the extent relevant, the disclaimer set forth in the relevant PDS or Guide Specification applies to this document. 7470-CRC ksk 09022021.docx

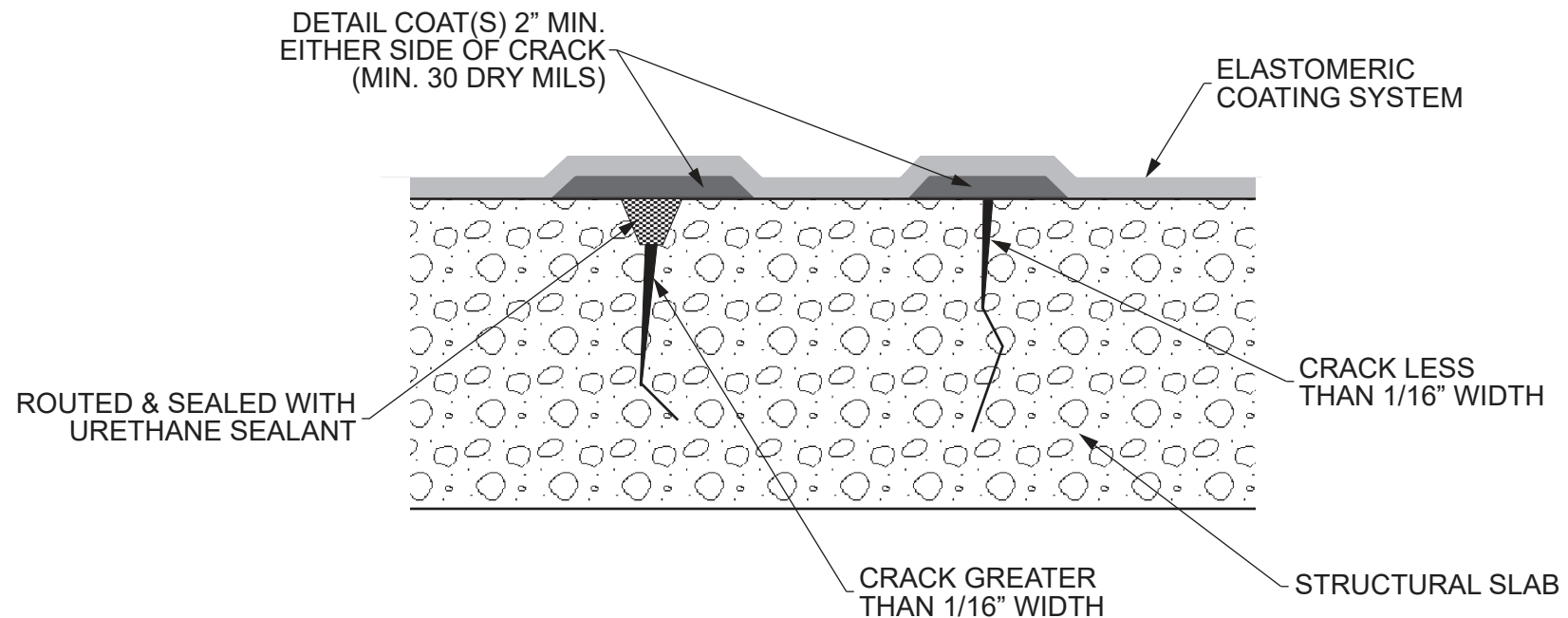

Note: This detail is utilized in the specification and design of fluid-applied waterproofing, in both new and retrofit applications. It is provided to show a generally recommended procedure for dealing with the condition shown. It will not and cannot provide a specific solution for every condition likely to be encountered in field application. Where field conditions differ, the use of applicable portions of the detail shown or its adaptation by an experienced and conscientious applicator should result in a quality project.



2728 Empire Central  
Dallas, Texas 75236  
(214)-353-1600  
www.neogard.com

Project:

Crack Treatment

Drawn by:

KSK

Scale:

NTS

Date:

03/31/2020

Drawing/Index No.

WPDC\_crack-03312020-01

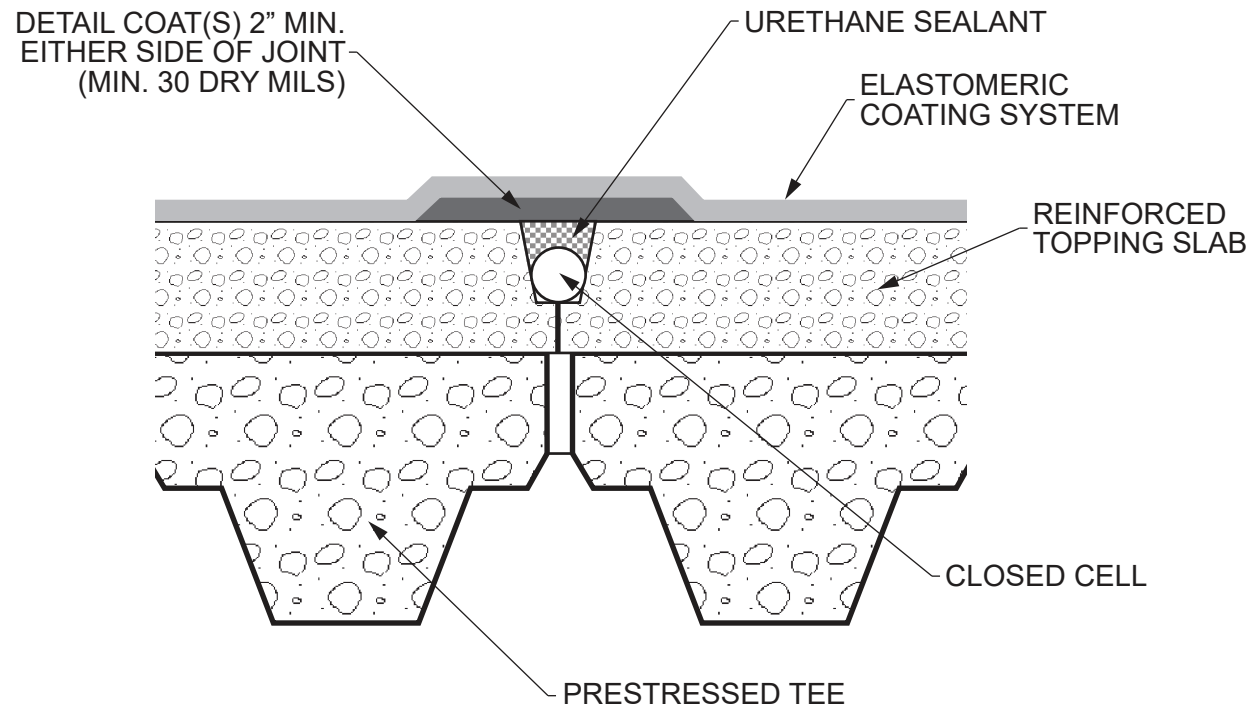

Note: This detail is utilized in the specification and design of fluid-applied waterproofing, in both new and retrofit applications. It is provided to show a generally recommended procedure for dealing with the condition shown. It will not and cannot provide a specific solution for every condition likely to be encountered in field application. Where field conditions differ, the use of applicable portions of the detail shown or its adaptation by an experienced and conscientious applicator should result in a quality project.



2728 Empire Central  
Dallas, Texas 75236  
(214)-353-1600  
www.neogard.com

Project:

Double-Tee Crack Control

Drawn by:

KSK

Scale:

NTS

Date:

04/01/2020

Drawing/Index No.

WPDC\_double-tee-04012020

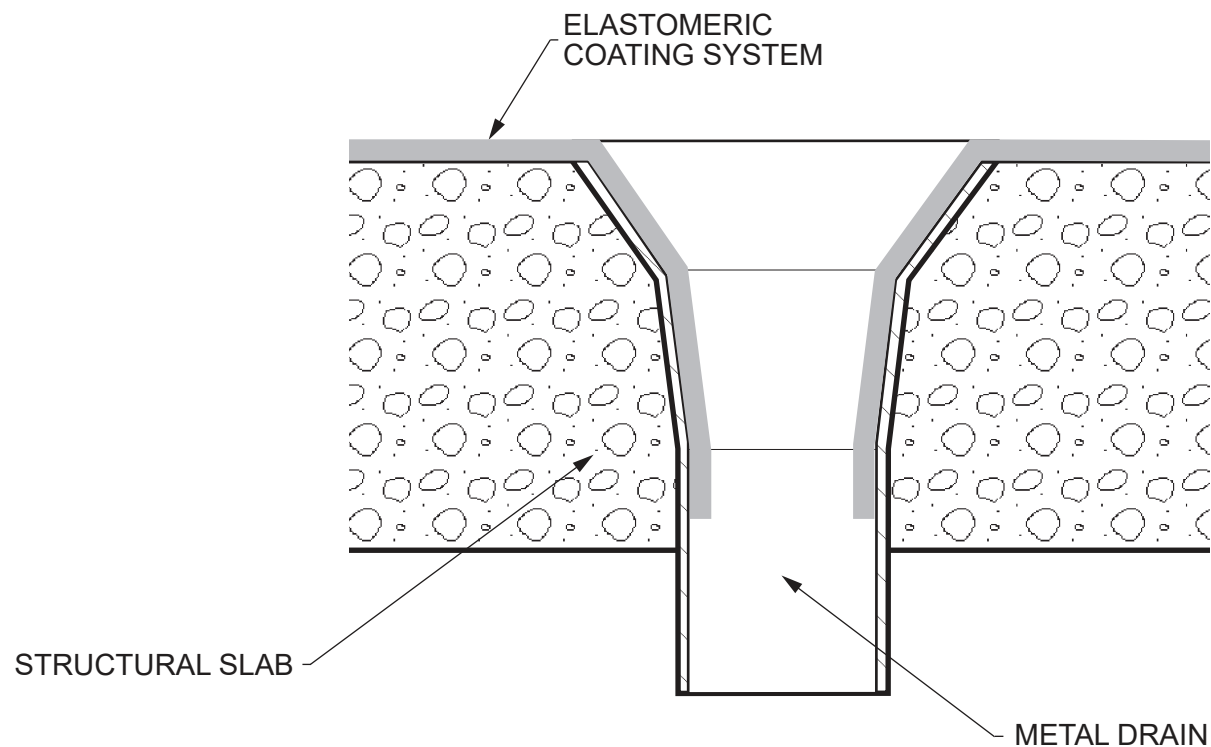

Note: This detail is utilized in the specification and design of fluid-applied waterproofing, in both new and retrofit applications. It is provided to show a generally recommended procedure for dealing with the condition shown. It will not and cannot provide a specific solution for every condition likely to be encountered in field application. Where field conditions differ, the use of applicable portions of the detail shown or its adaptation by an experienced and conscientious applicator should result in a quality project.



2728 Empire Central  
Dallas, Texas 75236  
(214)-353-1600  
www.neogard.com

Project:

Deck Drain

Drawn by:

KSK

Scale:

NTS

Date:

04/01/2020

Drawing/Index No.

WPDC\_drain-04012020-01

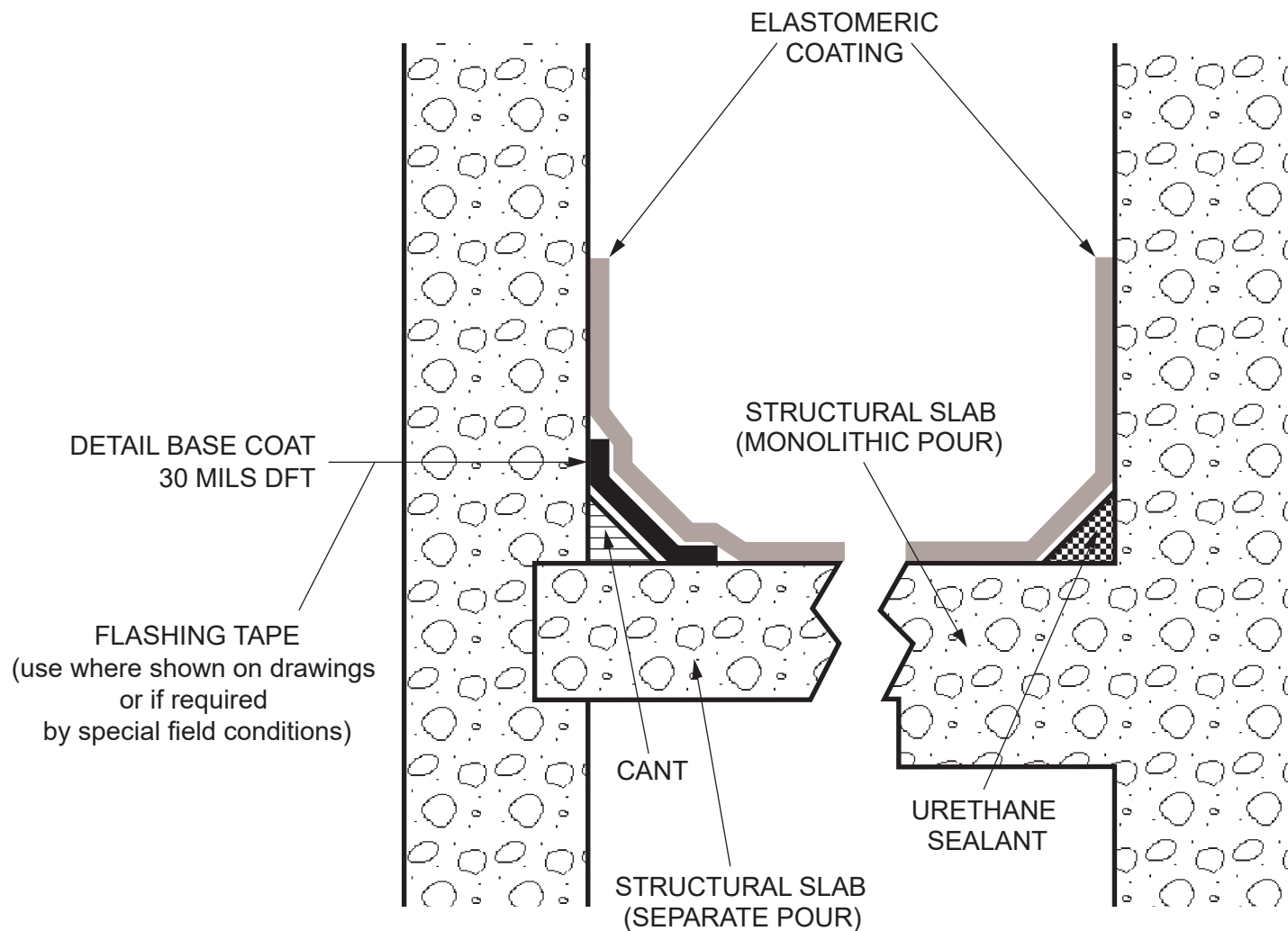

Note: This detail is utilized in the specification and design of fluid-applied waterproofing, in both new and retrofit applications. It is provided to show a generally recommended procedure for dealing with the condition shown. It will not and cannot provide a specific solution for every condition likely to be encountered in field application. Where field conditions differ, the use of applicable portions of the detail shown or its adaptation by an experienced and conscientious applicator should result in a quality project.



2728 Empire Central  
Dallas, Texas 75236  
(214)-353-1600  
www.neogard.com

Project:

Typical Deck Flashing

Drawn by:

KSK

Scale:

NTS

Date:

10/29/2020

Drawing/Index No.

WPDC\_flashing-10292020

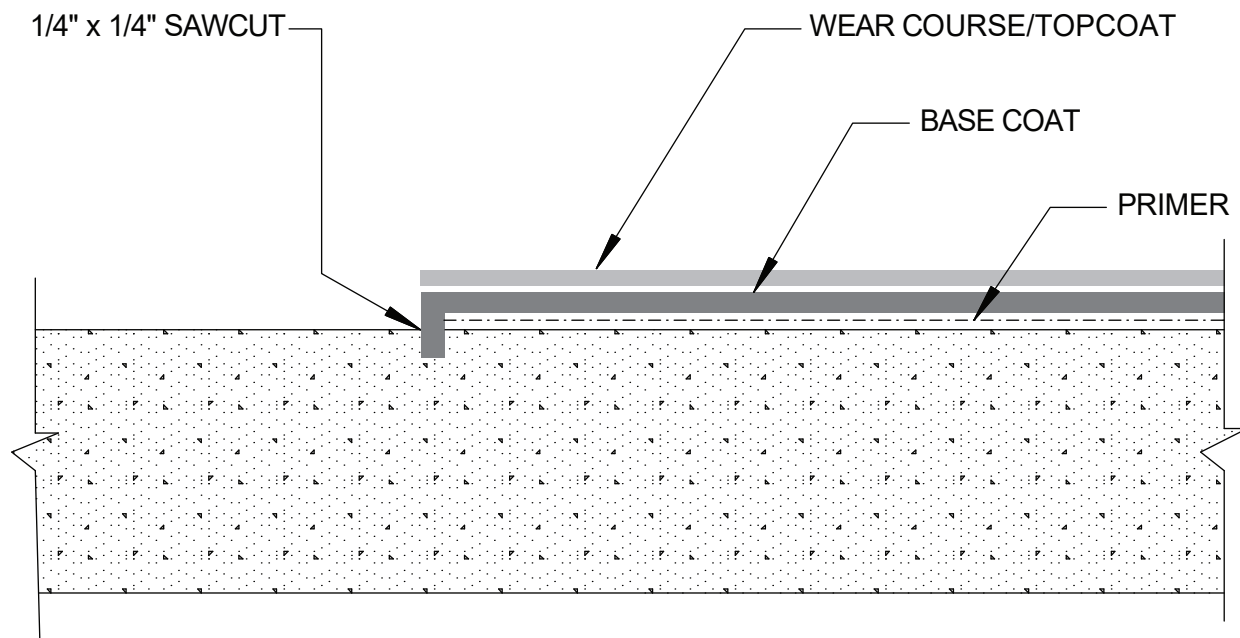

Note: This detail is utilized in the specification and design of fluid-applied waterproofing, in both new and retrofit applications. It is provided to show a generally recommended procedure for dealing with the condition shown. It will not and cannot provide a specific solution for every condition likely to be encountered in field application. Where field conditions differ, the use of applicable portions of the detail shown or its adaptation by an experienced and conscientious applicator should result in a quality project.



2728 Empire Central  
Dallas, Texas 75236  
(214)-353-1600  
www.neogard.com

Project:

Horizontal Termination

Drawn by:

K. Kirby

Scale:

NTS

Date:

04/01/2020

Drawing/Index No.

WPDC\_horiz-term-04012020

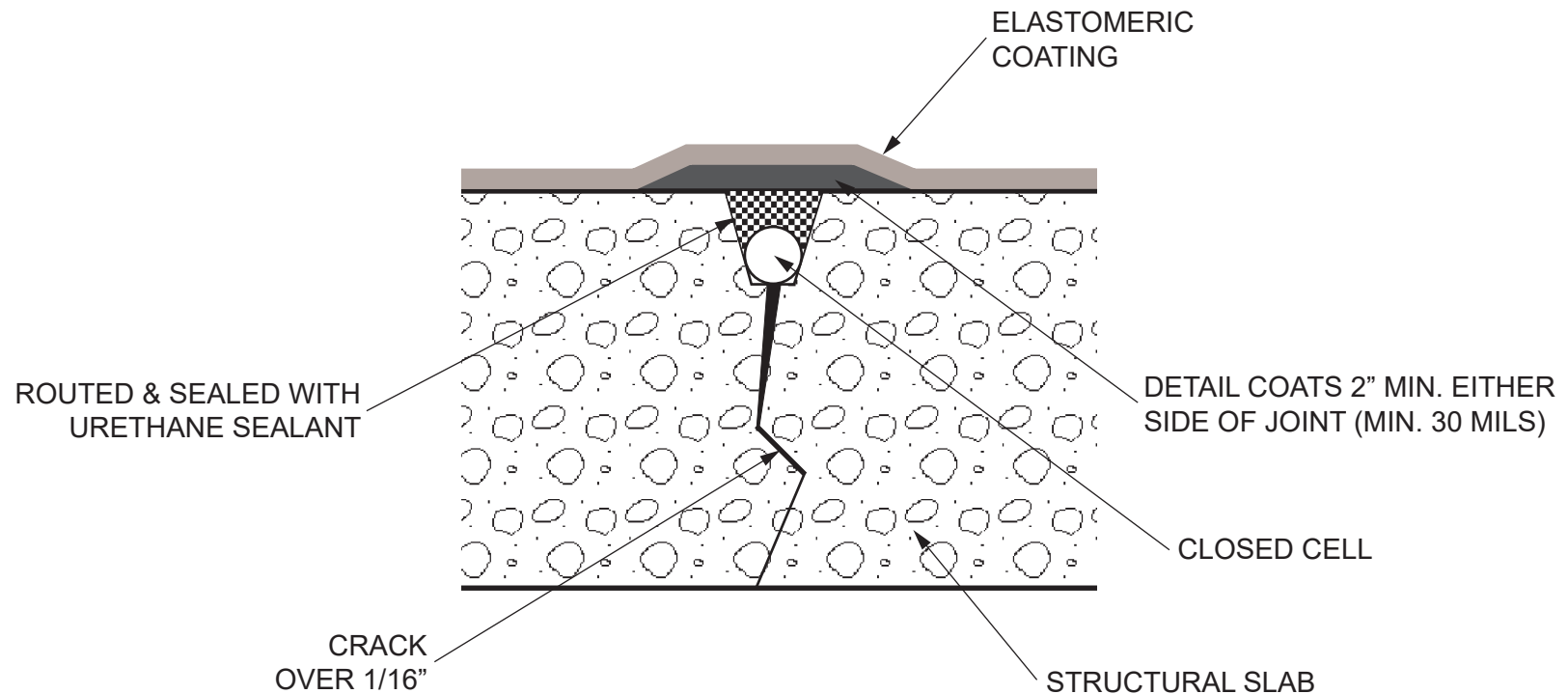

Note: This detail is utilized in the specification and design of fluid-applied waterproofing, in both new and retrofit applications. It is provided to show a generally recommended procedure for dealing with the condition shown. It will not and cannot provide a specific solution for every condition likely to be encountered in field application. Where field conditions differ, the use of applicable portions of the detail shown or its adaptation by an experienced and conscientious applicator should result in a quality project.



2728 Empire Central  
Dallas, Texas 75236  
(214)-353-1600  
www.neogard.com

Project:

Through-Slab Crack

Drawn by:  
K. Kirby

Scale:  
NTS

Date:  
04/01/2020

Drawing/Index No.  
WPDC\_through-slab-04012020



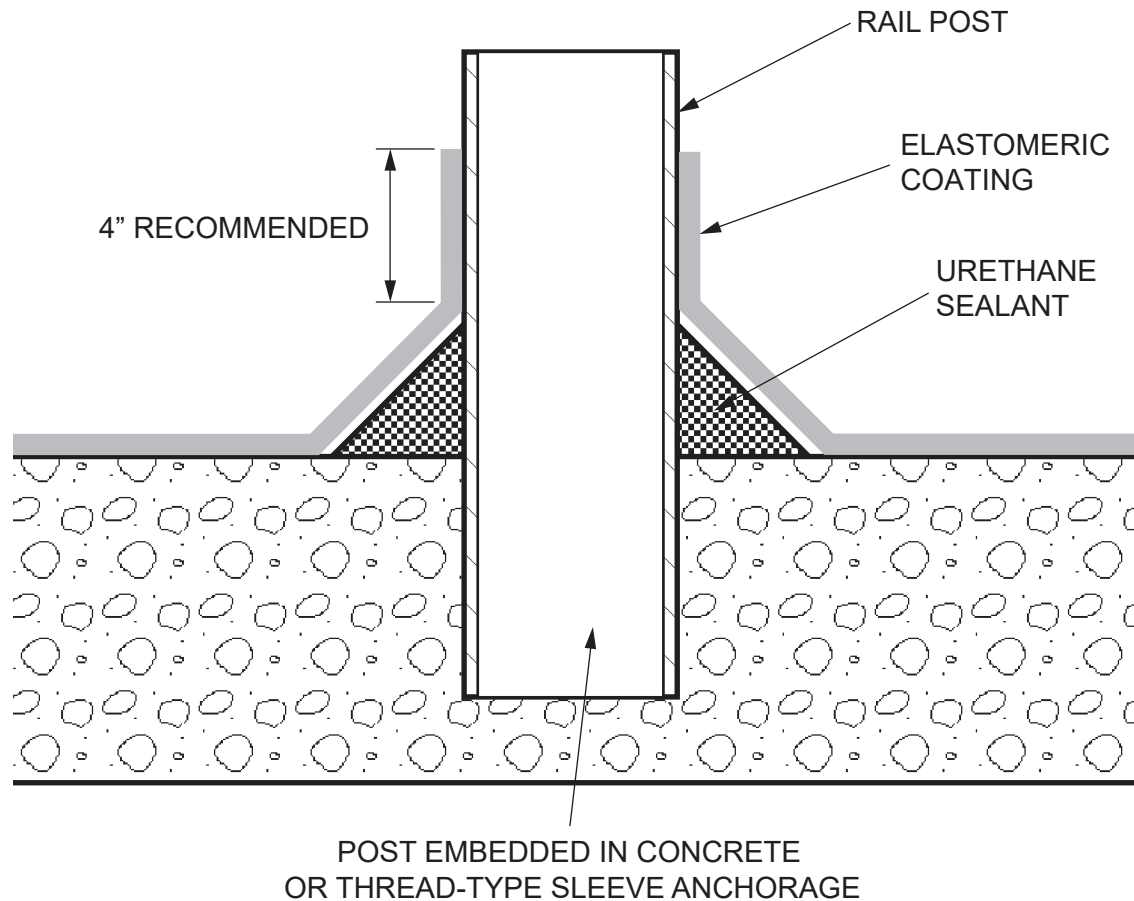

Note: This detail is utilized in the specification and design of fluid-applied waterproofing, in both new and retrofit applications. It is provided to show a generally recommended procedure for dealing with the condition shown. It will not and cannot provide a specific solution for every condition likely to be encountered in field application. Where field conditions differ, the use of applicable portions of the detail shown or its adaptation by an experienced and conscientious applicator should result in a quality project.



2728 Empire Central  
Dallas, Texas 75236  
(214)-353-1600  
www.neogard.com

Project:

Vertical Projection

Drawn by:

K. Kirby

Scale:

NTS

Date:

04/01/2020

Drawing/Index No.

WPDC\_vert-proj-04012020